



## SEALING TAPE FOR CONSTRUCTION JOINTS IN CONTAINERS AND SILOS

# Agrar-SynkoElast

Seal biogas plants and plants for the storage and transfer of slurry, liquid manure and silage effluent permanently

Agrar-SynkoElast is a sealing tape approved by the DIBt: Z-74.51-184

**Agrar-SynkoElast is an internal joint tape for sealing construction joints in in-situ concrete structures, which stands out due to its quick and easy installation.**

Agrar-SynkoElast must be assembled on concrete that has set for at least 7 days (primer required). After that, construction can continue with in-situ concrete. During concrete hardening, the concrete and Agrar-SynkoElast tape bond together so that the penetration of water is stopped. The joint created between the concreting steps is sealed securely and permanently by Agrar-SynkoElast.

Agrar-SynkoElast is used for sealing storage and filling facilities with substances generally hazardous to water, such as biogas plants and plants for the storage and transfer of slurry, liquid manure and silage effluent, slurry tanks, silos, fermentation feed silos, waste water plants, and many more.

### Advantages at a glance:

- ✓ Fast and easy installation
- ✓ Resistant to slurry, liquid manure, silage effluent, acids, alkalis and salts.
- ✓ Processing from 0°C to 35°C
- ✓ Pressure-tight up to 4 m filling height
- ✓ No swelling on contact with water
- ✓ DIBt approval (AbZ No. Z-74.51-184)

**Agrar-SynkoElast** is a joint sealing system approved by the DIBt building authorities:  
Z-74.51-184

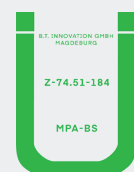

## In comparison: Agrar-SynkoElast and metal waterstops

Agrar-SynkoElast	Metal waterstop
::: Installation independent of weather conditions	::: Sheet metal fastening to reinforcement necessary
::: Ideal for mounting on precast concrete elements	::: Sealing ineffective with partially filled concrete, dirty metal sheets
::: Only a small concrete cover required	
::: Easy to install, even on angled surfaces	

**Suitable for:** (Concrete) Silage clamps and silage silos

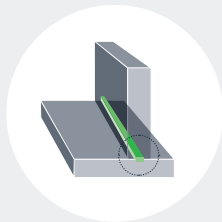

Ground floor plate and wall connections

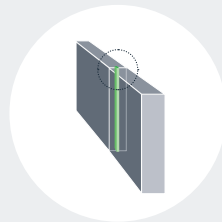

Wall and wall connections

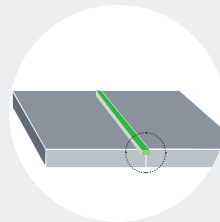

Ground floor plate and ground floor plate connections



Wall and ceiling connections

### Areas of use

Biogas plants and plants for the storage and transfer of lurry, liquid manure and silage effluent

Containers for liquid manure, slurry and in biogas plants

(Concrete) Silage clamps, fermentation feed silos

Waste water plants

Solid manure plates

### Technical information

<b>Consistency</b>	elastoplastic
<b>Temperature resistance</b>	-40 - +70°C
<b>Working temperature</b>	0°C - +35°C
<b>Chemical resistance</b>	liquid manure, slurry, silage effluent

**NOTICE:** PLEASE OBSERVE THE TECHNICAL DATA SHEETS, THE SAFETY DATA SHEETS AND THE APPROVAL NOTICE (Z-74.51-184).

### Application on hardened concrete



**01**

The concrete must have set for 7 days

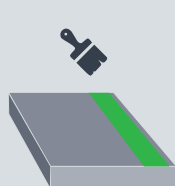

**02**

Apply the primer and allow to dry for 2 hours



**03**

Heat the concrete

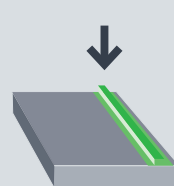

**04**

Press Agrar-SynkoElast onto the warm concrete

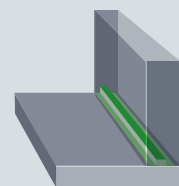

**05**

Concrete the adjacent component

**You have questions? Contact us!**

**B.T. innovation GmbH** \_ Sudenburger Wuhne 60 \_ 39116 Magdeburg\_ Germany  
Phone: +49 391 7352 21 \_ Email: export@bt-innovation.de

[www.bt-innovation.de](http://www.bt-innovation.de)