

Installation of the ProElast® system

The ProElast® system can be used to reliably seal construction joints, crack control sections and expansion joints against ground moisture, non-pressing, temporarily accumulating and pressing water.

It consists of the following components:

::: ProElast® Foil 1.0 or ProElast® Foil 1.5 (EPDM waterproofing membranes of various foil thicknesses).

::: InnoElast® Type 1 or InnoElast® Type 2 (joint and surface adhesive)

The sealing of construction joints and crack control sections is described in more detail below.

SURFACE PREPARATION

01 - Clean surface

The surface to be sealed must be load-bearing and free of grease and dust. It must not be chalky or sandy. Cement skin, protruding ridges, impurities and old coatings must be removed. The surface can be prepared by blasting with high-pressure water. If form-work oils cannot be removed completely, the surface must be pre-treated / cleaned.

The InnoElast® Type 1 or InnoElast® Type 2 adhesive may be applied to both dry and matt damp substrates. Wet, water-saturated substrates must be dried before application. Required fillets and fillets in corners must be made using system-compatible repair mortars. Edges must be chamfered to prevent damage to the ProElast® film. Gravel pockets, cavities or other defects must be filled flush with the surface using a system-compatible repair mortar before applying the waterproofing system.



PROCESSING AS SURFACE COATING

02 - Applying the InnoElast® adhesive

The InnoElast® type 1 or InnoElast® type 2 adhesive is applied to the cleaned surface in approx. 15 mm thick beads using a hand press when applying 600 ml tubular bags.



03 - Spreading the adhesive with a notched trowel

The distribution on the surface should be carried out with a notched trowel B3, so that an even layer of adhesive with a thickness of approx. 1.5 mm is created on the surface to be sealed.



04 - Laying and pressing on the ProElast® foil

The ProElast® foil is placed on the adhesive layer and rolled into the adhesive from the inside to the outside with a wide pressure roller. The contact pressure must be selected so that, on the one hand, no air bubbles remain under the foil and, on the other hand, the adhesive is not pressed out at the free edges. Excess adhesive outside the foil must be removed before sealing.

05 - Transitions through overlaps

The ProElast® sheeting must be made up to fit the course of the joint. Required overlaps of the ProElast® foil at the edges of the foil web are to be formed in a length of 100 mm by full-surface bonding. Inside corners can be sealed by cutting the foil in half and overlapping half of the foil. The width of the foil must be selected according to the intended use. For use as a joint seal against high-pressure water, the minimum required width is 300 mm. In the area of the floor/wall connection with a protruding floor slab, the ProElast® foil must be led down from the wall area over the floor slab to at least 100 mm onto the face of the floor slab.



06 - Sealing the foil edges

Finally, all film edges of the ProElast® foil are edge-sealed with InnoElast® type 1 or with InnoElast® type 2 and spread on the surface so that no free foil edge is visible. All waterproofing with the ProElast® system in the area in contact with the ground must be protected against mechanical damage with a suitable full-surface protective layer before backfilling.

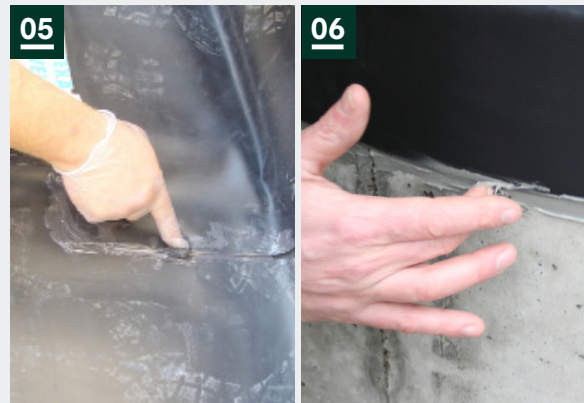

CONSUMPTION AND MINIMUM JOINT SEALANT

Note:

Consumption figures are based on experience and may vary depending on substrate conditions. In the table illustrated, you will find an overview of the consumption quantity of InnoElast® adhesive.

Foil width [cm]	Consumption InnoElast® Type1 and Type2 [ml/m]
20	300
25	375
30	450
40	600
50	750
80	1200
100	1500
150	2250

YOU HAVE FURTHER QUESTIONS?

B.T. innovation GmbH _ Sudenburger Wuhne 60 _ 39116 Magdeburg _ Germany
Tel. +49 391 7352 21 _ Fax +49 391 7352 52 _ export@bt-innovation.de



Issue 06/20 – In all cases of doubt, the current technical data sheets and the general test certificate issued by the building authorities apply and are intended to supplement these instructions. These installation instructions have been technically revised. Previous editions are invalid. In case of a technically revised new edition, this edition loses its validity. Please find out whether you are in possession of the current edition.